

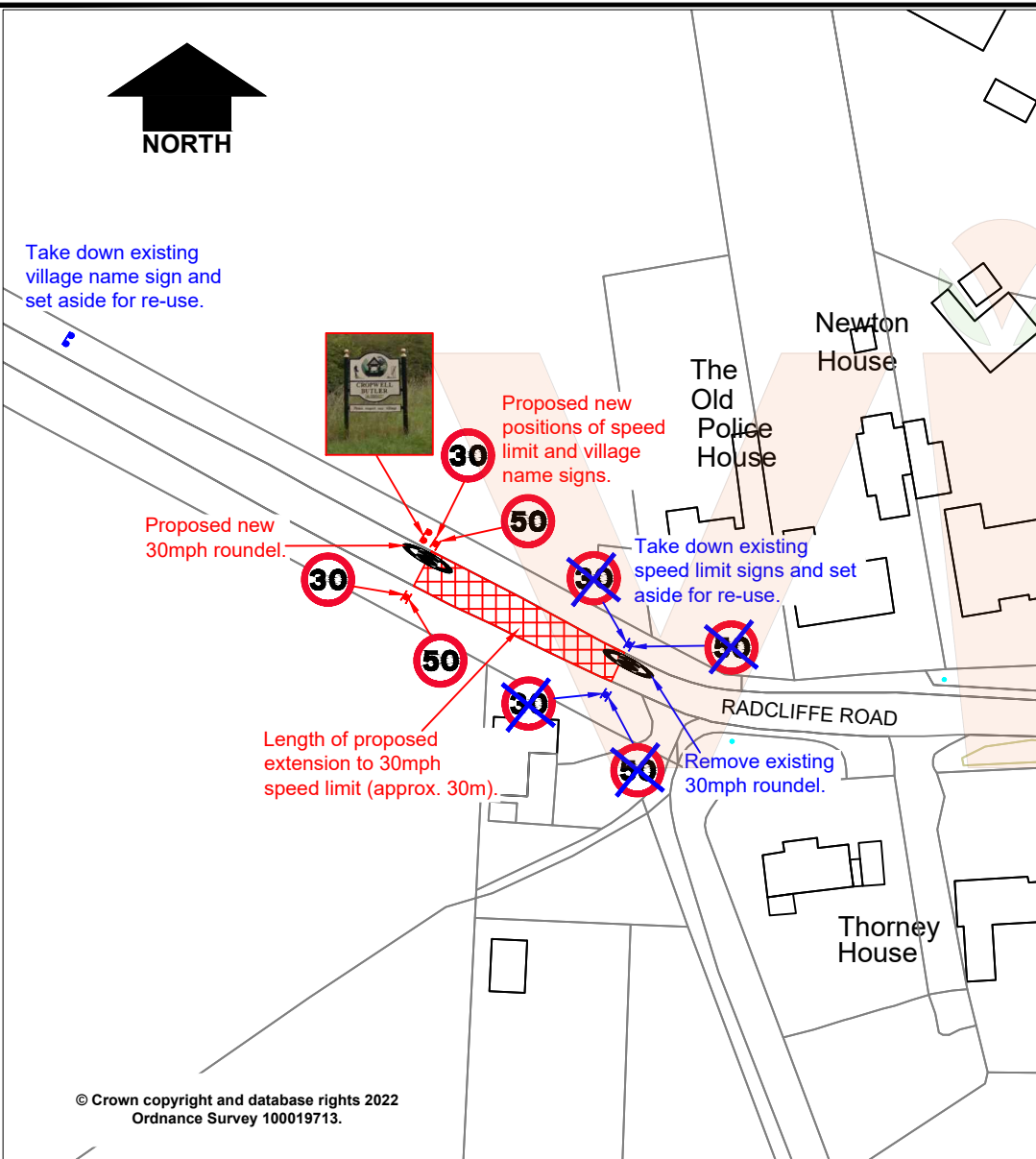

Take down existing village name sign and set aside for re-use.

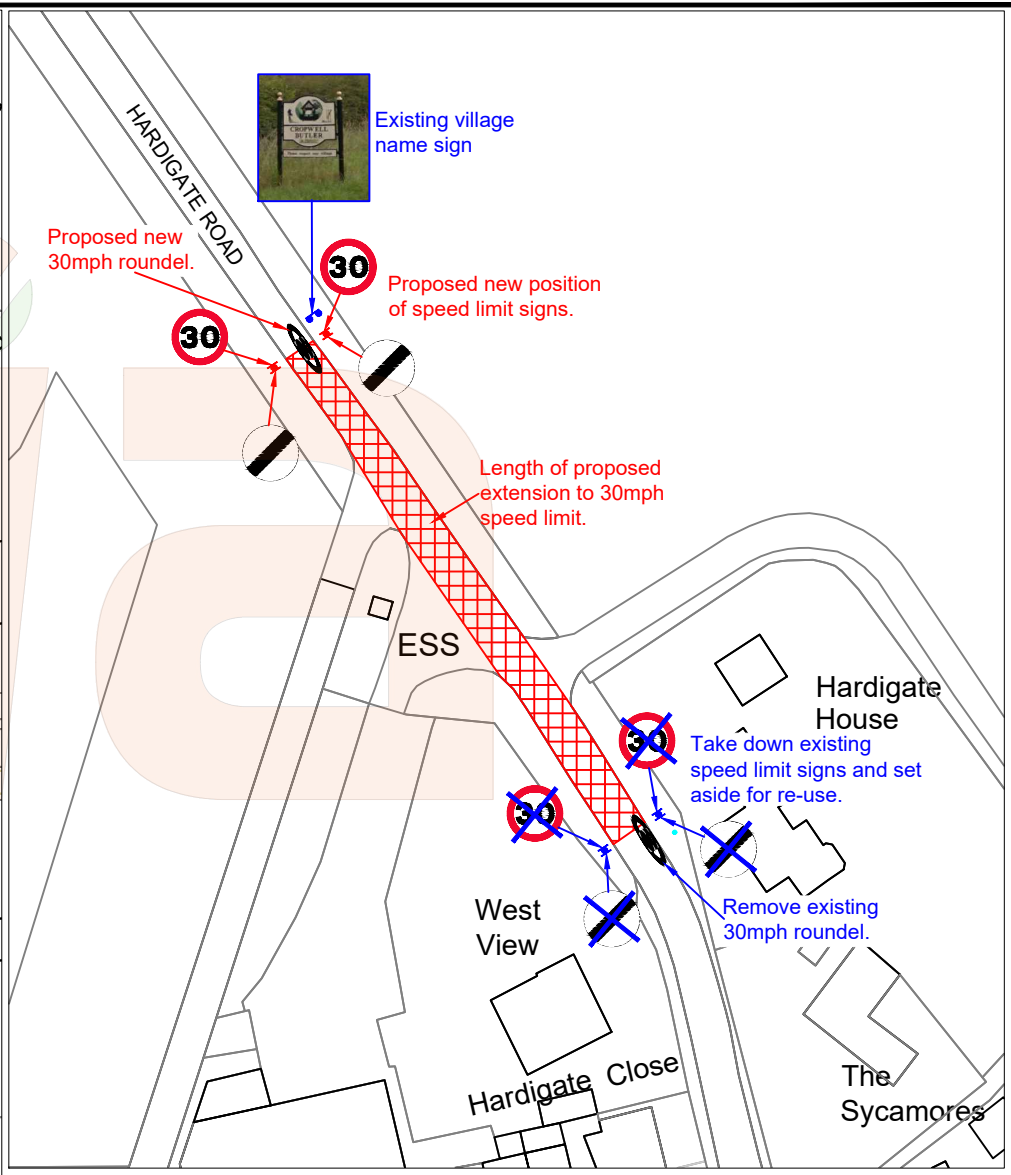

© Crown copyright and database rights 2022
Ordnance Survey 100019713.



in partnership with
Nottinghamshire County Council
www.viaem.co.uk Tel 0115 804 2100
Bilsthorpe Depot, Bilsthorpe Business Park, Bilsthorpe,
Nottinghamshire, NG22 8ST

Project		Hardigate Rd and Radcliffe Rd, Cropwell Butler				Drawn	J.A.B.	Date	Aug. 22
Status	Project No.	TRO 8344				Ch'kd	M.N.	Date	Aug. 22
Drawing Title		Proposed 30mph Speed Limit Extension - Plan				Auth		Traced	
Drawing No.		H/JAB/4004/01				Rev.		Scale	1:1000 @A4

Aug 18, 2022 - 8:52am: U:\Highways\One Programme\2022\23\TP2265 347 Hardigate Rd Radcliffe Rd Cropwell Butler\B Design Phase\807 TRO\Hardigate Rd Radcliffe Rd Cropwell Butler 30mph SLO PLAN.dwg