

KEY



Proposed double yellow lines (no waiting at any time)



Proposed bus stop clearway. No stopping at any time, except buses



NORTH

Bus Stop Refs:
AS0289 and AS0290.
Proposal to install a 19 metre clearway at each of these stops.
Restriction: no stopping at any time except buses

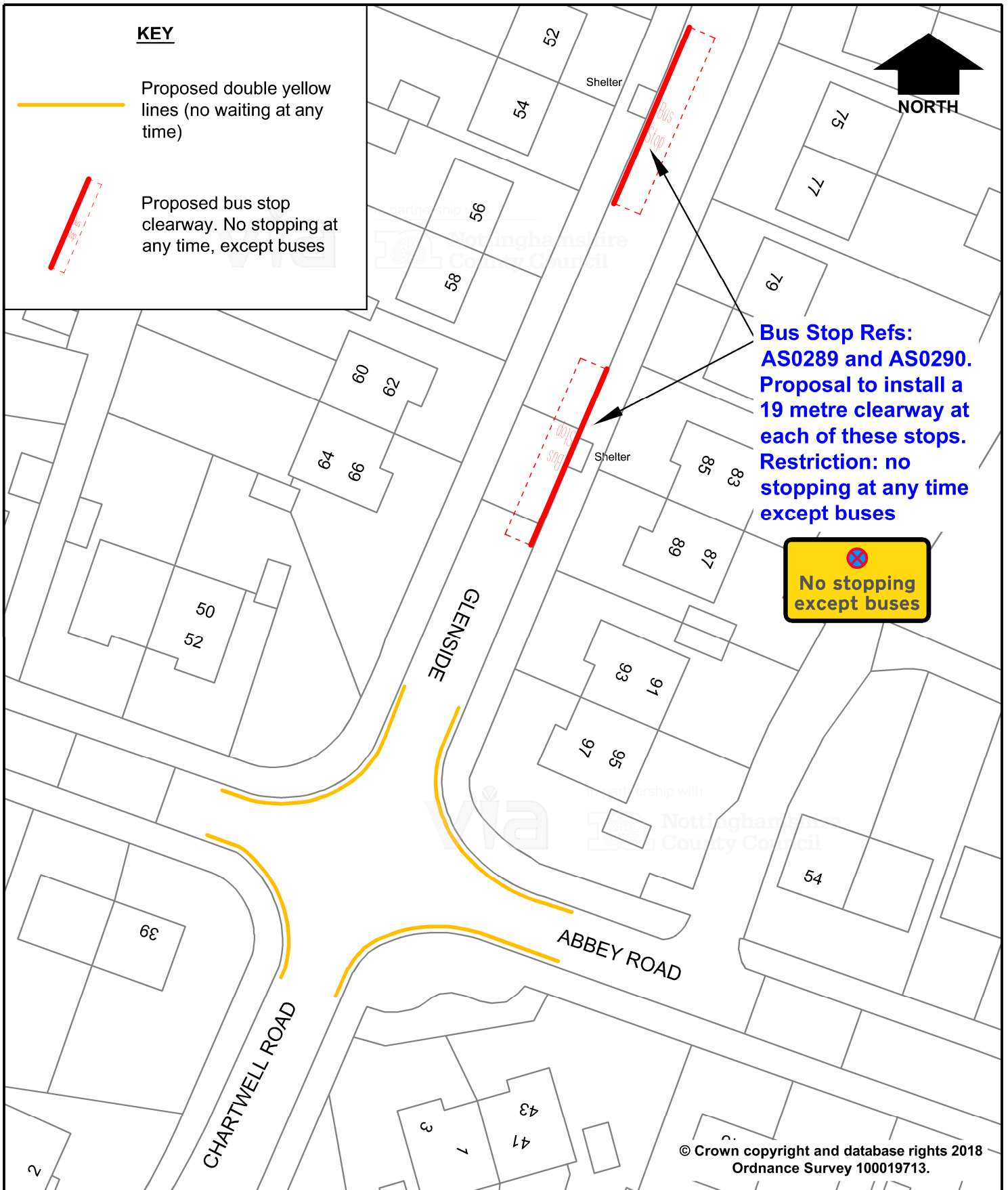

© Crown copyright and database rights 2018
Ordnance Survey 100019713.



in partnership with



**Nottinghamshire
County Council**

www.viaem.co.uk Tel 0115 8042100
Bilthorpe Depot, Bilthorpe Business Park,
Bilthorpe, Nottinghamshire NG22 8ST

Project

**Abbey Road, Chartwell Road & Glenside
Kirkby-in-Ashfield**

Drawn

JMR

Date

Mar '18

Chkd

SLW

Date

Mar '18

Status

Advert

Project No.

TRO 4213

HW 20100

Auth

HN

Traced

Title

**Proposed Double Yellow Lines
and Bus Stop Clearways**

Scale

1:500

Drawing No.

H/JMR/2666/01

Rev