



KEY



Proposed No Waiting
At Any Time (Double
Yellow Lines)



Existing Single Yellow Line
Mon - Fri 8am - 6pm



Existing H-Bar marking

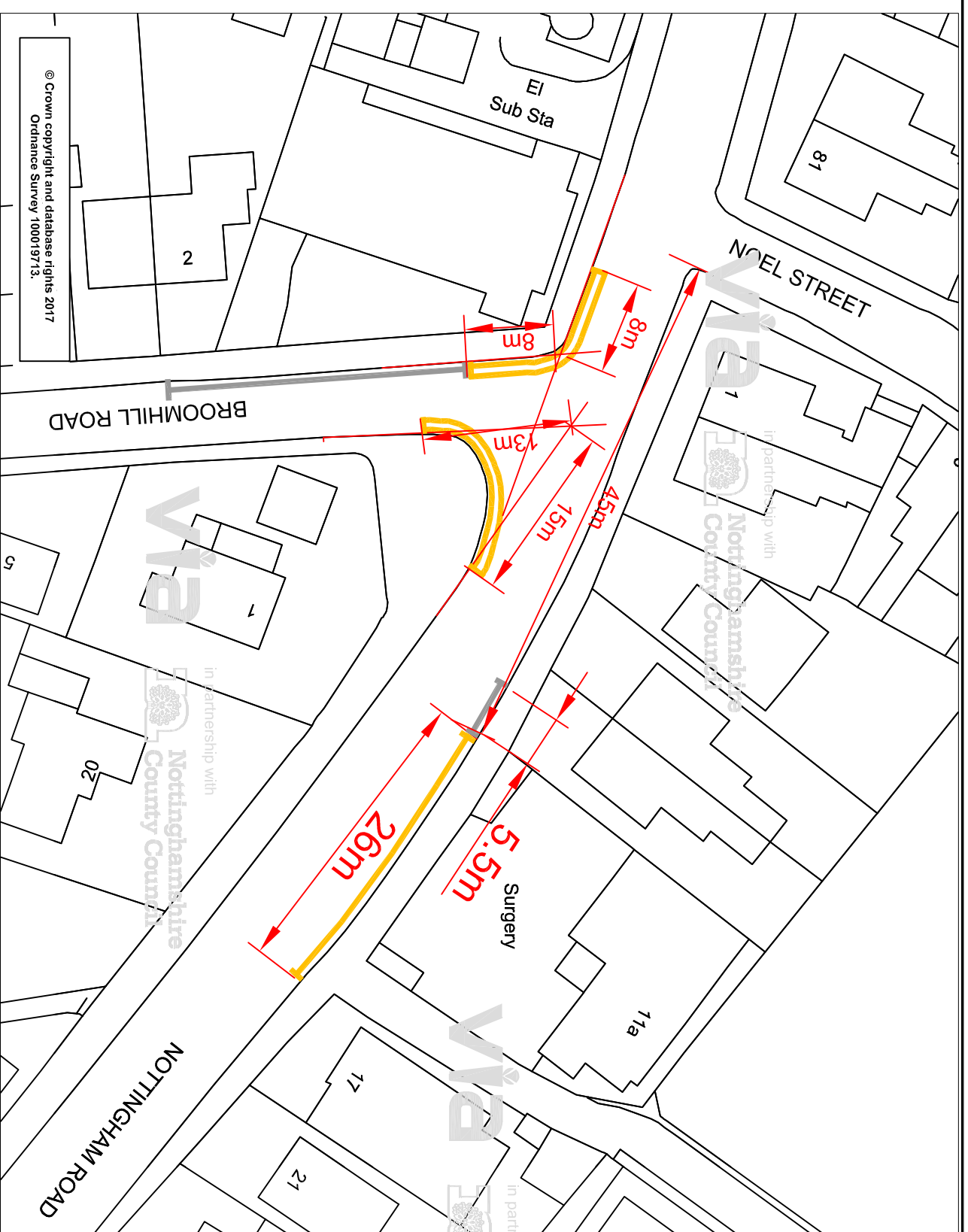

Rev	Description	Drawn	Chkd	Auth	Date

Project	Broomhill Road, Kimberley
Status	TRO 5240
Title	Proposed Double Yellow Lines
Drawing No.	H/LS/2459/01

Project	LS	Date	Sept '17
Chkd	SLW	Date	Sept '17
Auth	Traced	Scale	1:500



in partnership with
**Nottinghamshire
County Council**

www.viam.com.uk Tel 01623 873873
Bilshorpe Depot, Bilshorpe Business Park, Bilshorpe,
Nottinghamshire NG22 8ST

© Crown copyright and database rights 2017
Ordnance Survey 100019713.