

Road Traffic Regulation Act 1984

**The Nottinghamshire County Council (Bramcote Lane and Hall Drive, Chilwell)
(Prohibition of Waiting) Traffic Regulation Order 2020 (5295)**

NOTICE IS HEREBY GIVEN that the Nottinghamshire County Council proposes to make an Order under the Road Traffic Regulation Act 1984, as amended, Traffic Management Act 2004, as amended, and The Civil Enforcement of Parking Contraventions (County of Nottinghamshire) Designation Order 2008 (SI 2008 No. 1086), as amended, the effects of which will be in respect of roads at Chilwell in the Borough of Broxtowe: -

1. Vehicles will be prohibited from **waiting at any time** along: -

BRAMCOTE LANE, CHILWELL (the east side)

- from a point 12 metres north of its junction with Hall Drive in a southerly direction to a point 12 metres south of that junction

HALL DRIVE, CHILWELL (the north side)

- From its junction with Bramcote Lane in an easterly direction for 16 metres

HALL DRIVE, CHILWELL (the south side)

- From its junction with Bramcote Lane in an easterly direction for 16 metres

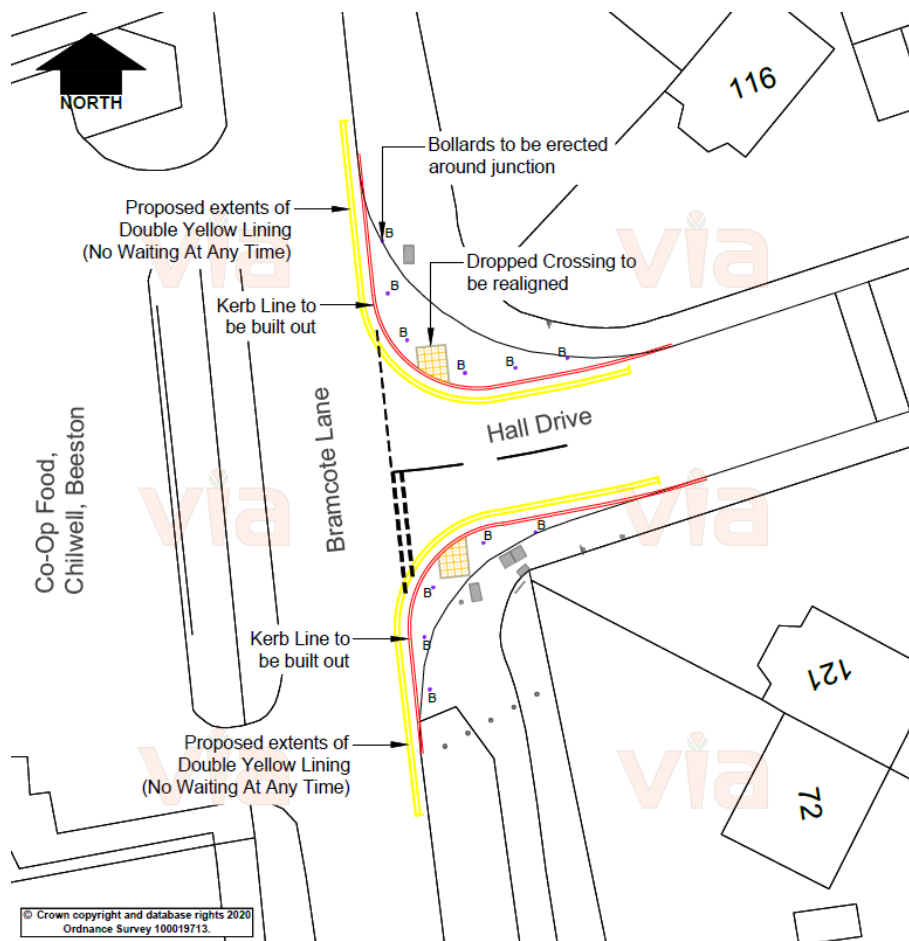

As a result of the impact of COVID-19 and in accordance with Public Health England's advice on social distancing and avoiding non-essential trips, public buildings such as County Hall libraries are closed or if reopened will have restrictions in place.

In order to make relevant documents available for inspection they can either be:

- (a) Viewed online by visiting the County Council's website (consult.nottinghamshire.gov.uk)
- (b) By writing to the address below or by emailing tmconsultation@viaem.co.uk to request a copy and one will be sent out either via email or post if address provided.

Written comments / objections either by letter or email to tmconsultation@viaem.co.uk (stating grounds and quoting ref.5295) must be received by the **22nd November 2020**. Any details you provide may be shared with Nottinghamshire County Council as appropriate. If you'd like to find out more about how we use your data, please see our Privacy Notice: www.viaem.co.uk/privacy-notice-for-the-public/

The restrictions are required to improve visibility at the above junctions and improve access for larger vehicles.

**Lead Design,
Via East Midlands,
Major Projects and Improvements,
Bilsthorpe Depot,
Bilsthorpe Business Park,
Eakring Road,
Bilsthorpe,
Nottinghamshire, NG22 8ST**

If you'd like to find out more about how we use your data, please see our Privacy Notice:
www.viaem.co.uk/privacy-notice-for-the-public/